

HUNTERS®

HERE TO GET *you* THERE



Lisburn Road

Bristol, BS4 1NE

£1,500 Per Month

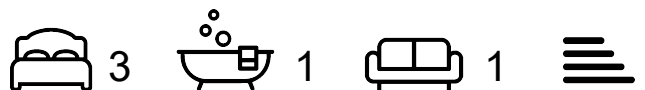

A recently refurbished three bedroom semi detached home on Lisburn Road in Knowle. with front and rear gardens,, off street parking and a garage. AVAILABLE NOW!

Please email in your enquiry to receive a pre application form before we can book you an internal viewing.
Knowle.bristol@hunters.com



- Entrance Hall
- Lounge
- Kitchen
- Bathroom
- Cloakroom
- Landing
- Bedroom One
- Bedroom Two
- Bedroom Three
- Rear Garden
- Gargae and Off Street Parking

Area Map

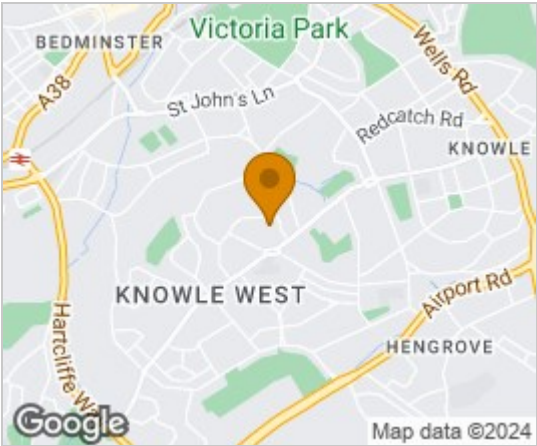

Floor Plans

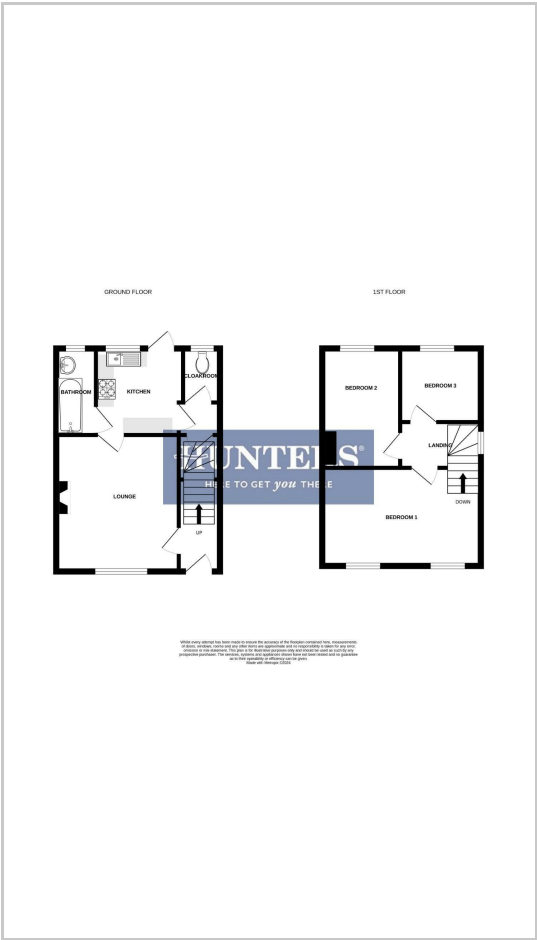

Energy Efficiency Graph



These particulars are intended to give a fair and reliable description of the property but no responsibility for any inaccuracy or error can be accepted and do not constitute an offer or contract. We have not tested any services or appliances (including central heating if fitted) referred to in these particulars and the purchasers are advised to satisfy themselves as to the working order and condition. If a property is unoccupied at any time there may be reconnection charges for any switched off/disconnected or drained services or appliances - All measurements are approximate. **THINKING OF SELLING?** If you are thinking of selling your home or just curious to discover the value of your property, Hunters would be pleased to provide free, no obligation sales and marketing advice. Even if your home is outside the area covered by our local offices we can arrange a Market Appraisal through our national network of Hunters estate agents.